

Glycol Chiller LCB-3500G

Specifications



Internal number	141.00.000.00
Part number	LG3500-1/2P
Maximum distance, ft	up to 250
Capacity, BTU/h, evap 20 °F	3900
Glycol tank capacity, gal	2.1
Compressor power, hp	1/2
Dedicated circuit, amp	20
Plug type (NEMA #)	5-20P 
Voltage, V / frequency, Hz	115 / 60
Pump type	Vane with 1/3 hp motor
Pump, GPH	100
Number of pre-installed pumps	1
Number of additional pumps	n/a
Refrigerant	R134a
Width, in	17.3
Depth, in	16.3
Height, in	27.3
Weight gross/net, lb	121 / 115
Power cord length, ft	6
Inlet/Outlet barb, in	3/8
Operating ambient temperature, °F	65-90
Clearance at least	12" around the entire unit
Glycol mixture, vol%	40 % glycol and 60% water

Overall dimensions

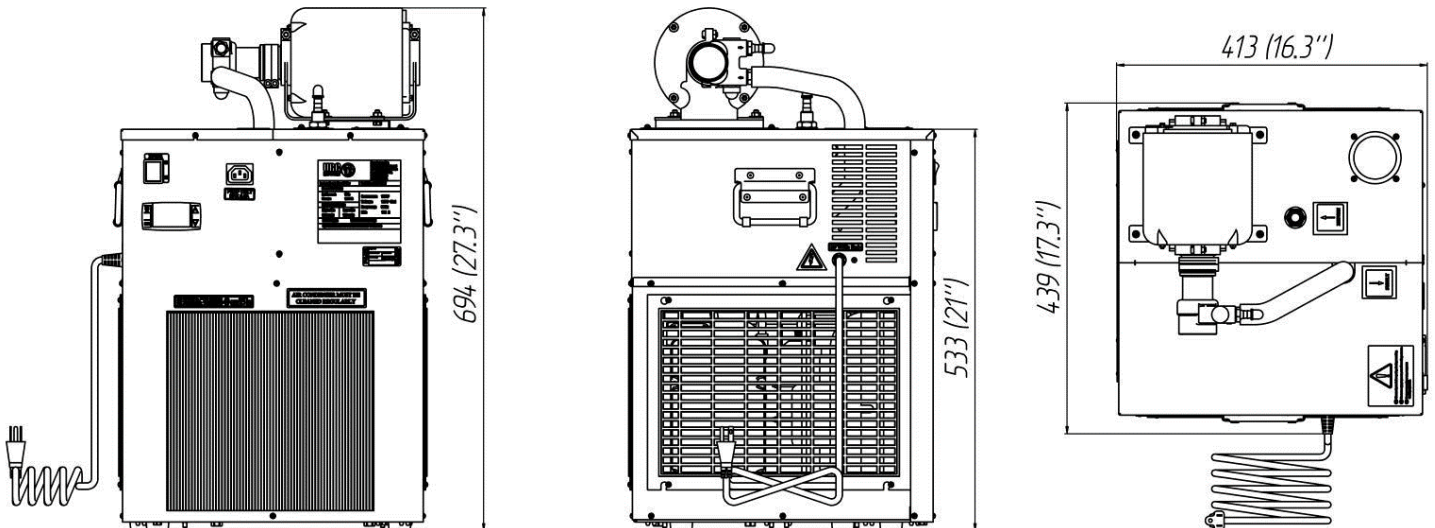

Glycol Chiller LCB-3500G

Wiring diagram

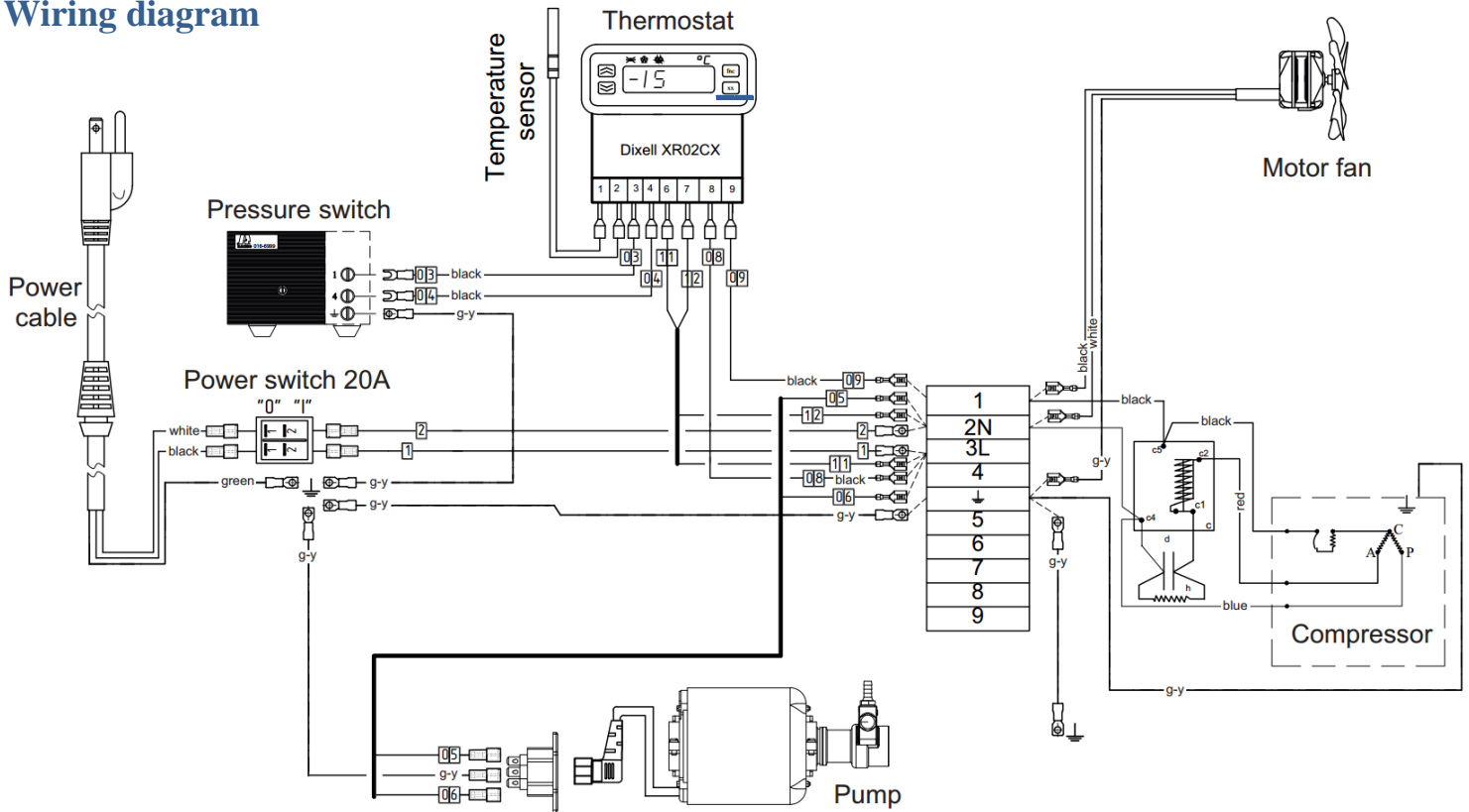

Parts

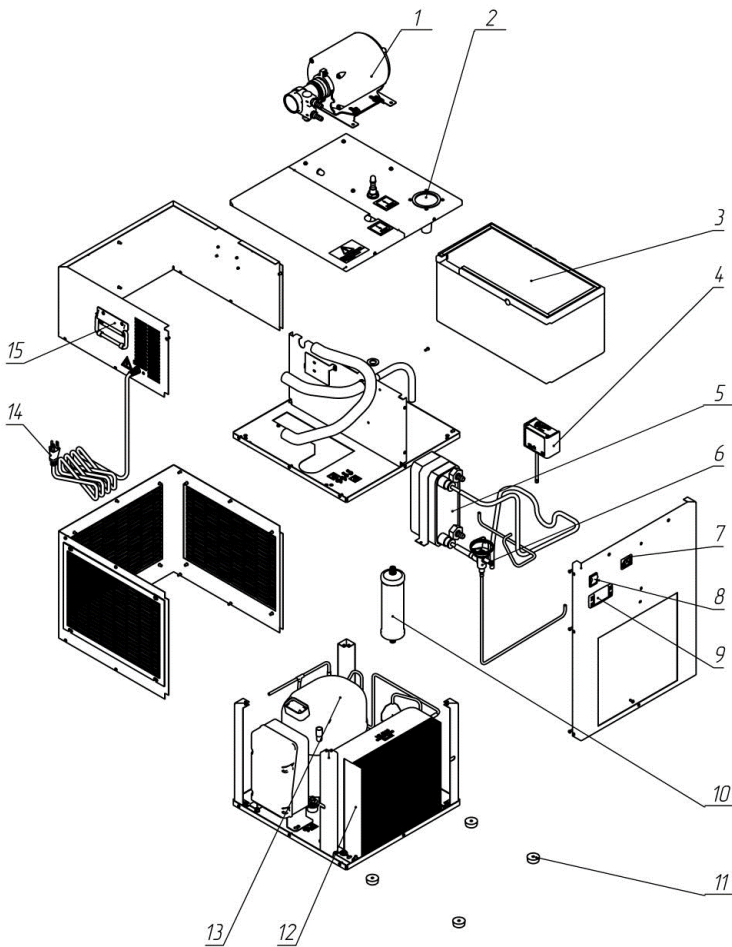

1	Glycol pump «FLUID-O-TECH» PA 2501 («PROCON» 102A080F11BA), cover to the pump « FLUID-O-TECH », set union joint « FLUID-O-TECH » 48 YZ and motor "MARATHON" 5KH32FN5586MX (115V/60Hz)
2	Cap
3	Glycol bath
4	Pressure switch "DANFOSS" KP-2
5	Plate heat exchanger "DANFOSS" C12L-EZ-20
6	Thermostatic expansion valve "DANFOSS" TUB R-134a 068U2003
7	Connector R302SN 250V 10A
8	Power switch "ARCOLECTRIC" C6053ALBR (Red)
9	Thermostat "DIXELL" XR02CX-4N0F1 (115 V/ 60Hz)
10	Hermetic receiver filter drier "DANFOSS" DMC2032S
11	Foot
12	Air condenser "LU-VE" STVF 194
13	Compressor "TECUMSEH" CAJ 4461 Y (100V-50Hz/115V-60Hz)
14	Power cord
15	Handle