

Glycol Chiller G30-3/8GP

Specifications



Internal number	113.00.000.00-10
Part number	G30-3/8GP
Maximum distance, ft	up to 125
Capacity, BTU/h, evap 20 °F	2600
Glycol tank capacity, gal	2.9
Evaporator	L=14380 mm.; 10.0 x 0.75 mm., Cu
Compressor power, hp	3/8
Dedicated circuit, amp	15
Plug type (NEMA #)	5-15P 
Voltage, V	115
Pump type	Vane with 1/3 hp motor
Pump, GPH	66
Number of pre-installed pumps	1
Number of additional pumps*	n/a
Refrigerant	R134a
Width, in	27.4
Depth, in	17.5
Height, in	14 / 19.4 (on legs)
Weight gross/net, lb	114 / 100
Power cord length, ft	6
Inlet/Outlet barb, in	3/8
Operating ambient temperature, °F	60-90
Clearance at least	12" around the entire unit
Glycol mixture, vol%	40 % glycol and 60% water

Overall dimensions

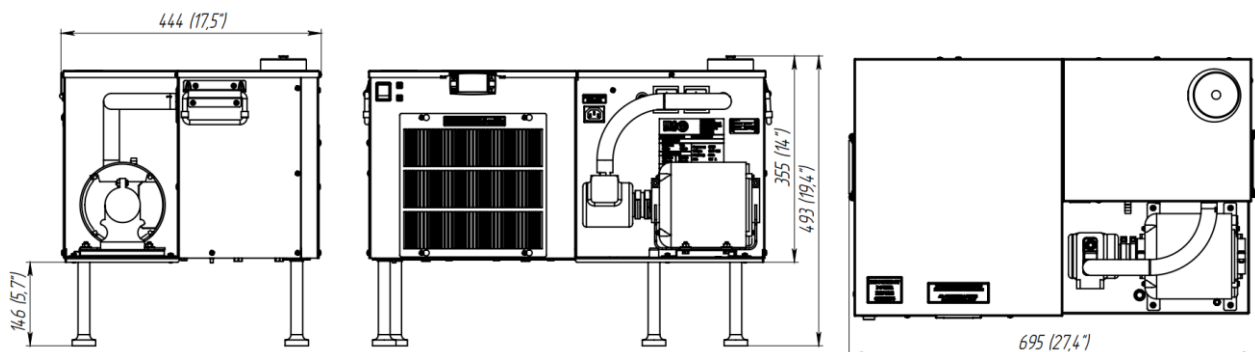

Glycol Chiller G30-3/8GP

Wiring diagram

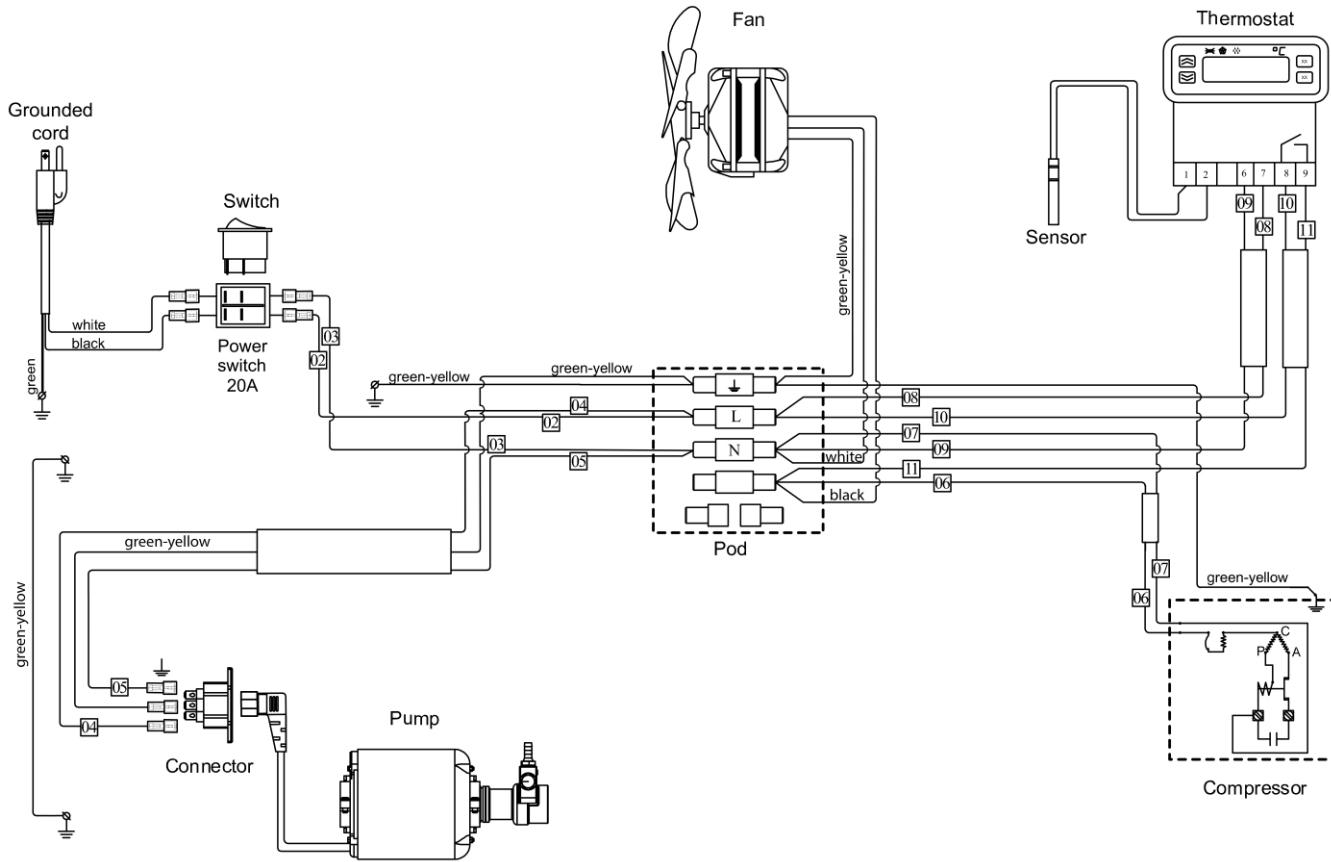

Parts

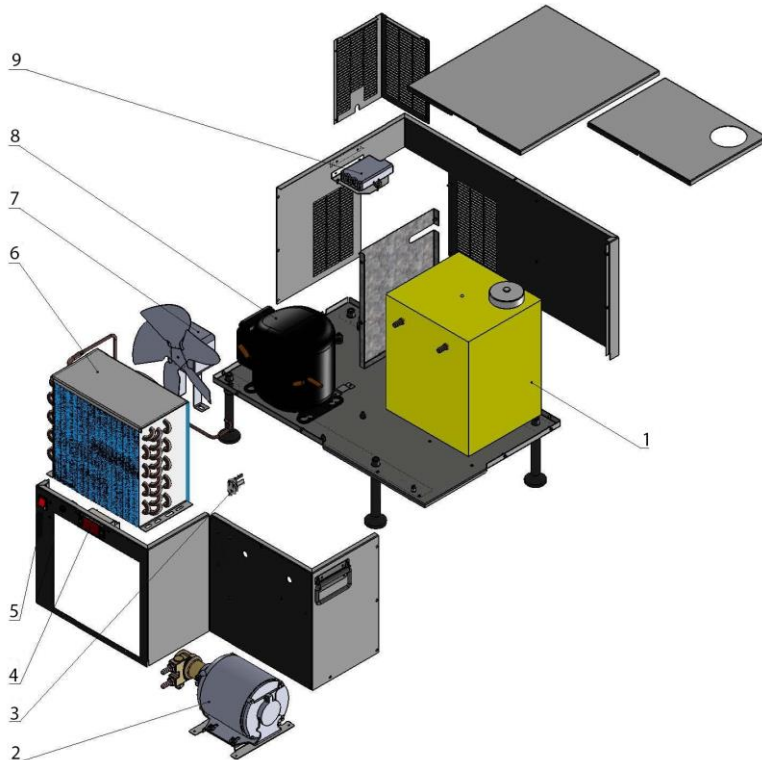

1	Glycol tank and evaporator
2	Glycol pump "FLUID-O-TECH" PA 1501 ("PROCON" 102A050F11BA) and motor "MARATHON" 5KH32FN5586MX (115 V/ 60 Hz)
3	Connector R302SN 250V 10A
4	Thermostat "DIXELL" XR02CX-4N0F1 (115 V/ 60Hz)
5	Power switch "ARCOLECTRIC" C6053ALBR (Red)
6	Air condenser "KARYER" B-18143 UL (2.33 m ²)
7	Electric motor "ELCO" NU 9-20-2/094 (115 V, 50-60 Hz) UL, Impeller plastic, Ø200 mm., $\alpha=28^{\circ}$
8	Compressor "EMBRACO" NEU 6210 Z (115 V/ 60 Hz)
9	Terminal block "ITW ELETTRIGIBI" PA104